

## AS & BS (3000 d/d & 1500 d/d) (Yumuşak veya Mekanik Salmastralı) **SALYANGOZ KAPLINLİ POMPALAR**

VOLUTE CASING LONG-COUPLED PUMPS (Soft Packing / Mechanical Seal)



### **TEKNİK ÖZELLİKLER**

- Kapasite: 20 - 120 m<sup>3</sup>/h
- Basma Yüksekliği: 27 - 88 m
- Devir Hızı:1500 - 3000 d/d
- Sıvı Sıcaklığı: -10 °C ~ + 110 °C
- Giriş Flanşları: DN80 - DN100
- Çıkış Flanşları: DN 65 - DN80 (Flanşlar opsiyoneldir.)
- Yatakla: Mil yatağındaki 2 adet ağır hizmet tipi rulmanla sağlanır/ Gres yağlamalı (opsiyonel)
- Eksenel yük çark dengeleme delikleri ile dengelenir
- İzolasyon sınıfı :F
- Koruma sınıfı :IP55
- Emme derinliği: 6.5mt.

### **MALZEME ÖZELLİKLERİ**

- Çark: Pk GG-25
- Emici ve Verici Gövde:Pk GG-25
- Mil: X20Cr13 (AISI420), Opsiyonel: AISI316 çelik
- Sızdırmazlık: Yumuşak veya Mekanik salmastra
- AS: Ø25 (Karbon/Seramik/Viton)
- BS: Ø30 (Karbon/Seramik/Viton)
- Kaplın: Elastik

### **KULLANIM ALANLARI**

- Temiz su temini
- Tarımsal sulama (Damlama ve Sprink sistemleri)
- Buhar kazanları bes,
- Kondens sistemleri
- Endüstri ve inşaatlar
- Soğutma sistemleri
- Sirkülasyon
- Yangın söndürme

### **OPSİYONEL**

- Açık Çark
- Bronz Çark
- AISI 316 / AISI 304 Çelik Mil

### **TECHNICAL DATA**

- Capacity: 20 - 120 m<sup>3</sup>/h
- Total Head: 27 - 88
- Rotation Speed:1500 - 3000 rpm
- Liquid Temp. :-10°C ~ +110°C
- Inlet Flanges: DN80 - DN100
- Outlet Flanges: DN65 - DN80 (Flanges are optional)
- Bearing: Pump Shaft is supported by 2 Heavy duty ball bearings on bearing housing / Grease lubricated (Optional)
- Axial load is reduced by balance holes
- Insulation Class: F
- Protection Class:IP55
- Suction lift: Max 6.5 m.

### **MATERIAL SPECIFICATIONS**

- Impellers: Cast iron GG-25
- Inlet & Outlet Bodies:Cast iron GG-25
- Pump Shaft: X20Cr13 (AISI420) steel, Optional: AISI316 stainless steel.
- Non-Leakage:Soft packing / Mechanical seal
- AS Ø25:( Carbon /Ceramic/Viton)
- BS Ø30: (Carbon /Ceramic/Viton)
- Coupling: Flexible

### **APPLICATIONS**

- Clean water supply
- Irrigation (Drip and Sprinkler systems)
- Boiler feeding, condens systems
- Industrial plants, Constructions
- Chiller systems
- Circulation
- Fire fighting

### **OPTIONAL**

- Open Impeller
- Bronze Impeller
- AISI 316 / AISI 304 S/S Shaft

## AS (3000 d/d) (Yumuşak veya Mekanik Salmastralı) SALYANGOZ KAPLINLI POMPALAR

VOLUTE CASING LONG-COUPLED PUMPS (Soft Packing / Mechanical Seal)

TİP TYPE	Bağlantı		MOTOR		m <sup>3</sup> /h	Debi (Q) - Capacity						Fiyat - Price (TL)		
	Giriş x Çıkış		HP	kW		20	30	40	50	60	70	Tek Pompa	Şasi + Kaplin	Pompa + Mot Akuple Pump+Mot.coupled
	Inlet x Outlet													
AS-4	3" x 2.5"		4	3	Hm (mSS)	27	25	20	13	5		2,290 ₺	360 ₺	3,590 ₺
AS-5.5			5.5	4		31	29	25	19	11		2,290 ₺	360 ₺	3,830 ₺
AS-7.5			7.5	5.5		36	34	31	26	20		2,290 ₺	360 ₺	3,840 ₺
AS-10			10	7.5		46	44	41	35	26	10	2,290 ₺	360 ₺	4,320 ₺
AS-15			15	11		57	55	52	48	40	19	2,300 ₺	400 ₺	5,190 ₺
AS-20			20	15		67	66	63	58	50	28	2,300 ₺	450 ₺	5,970 ₺

Flanşlar hariçtir. Takım fiyatı (Flange Set): 160 TL

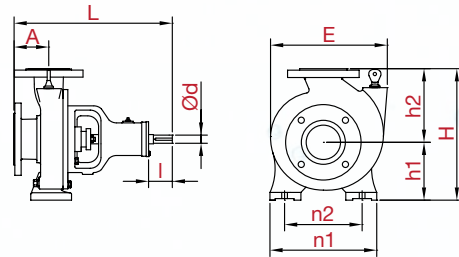
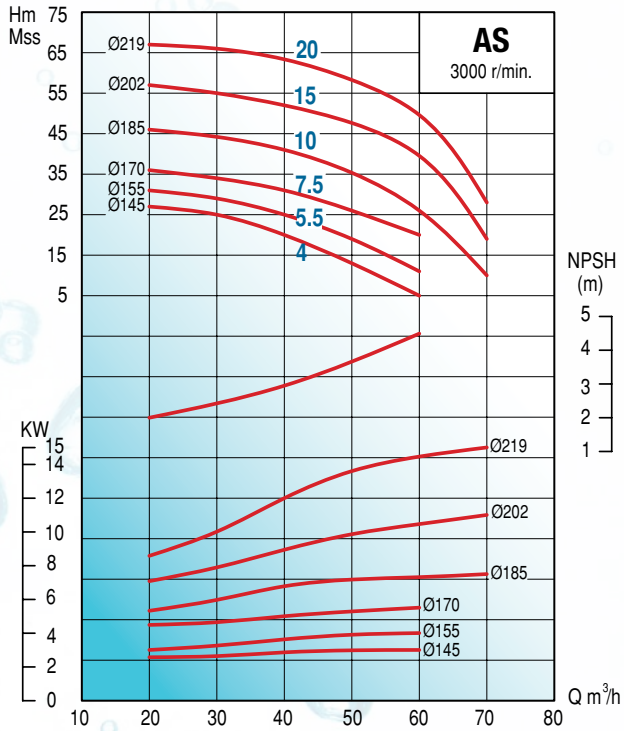

TİP TYPE	Boyutlar - Dimensions (mm)										Ağırlık - Weight
	A	L	h1	h2	H	E	n1	n2	I	d	Kg
AS	92	424	165	191	356	290	278	207	64	22	43

## BS (3000 d/d) (Yumuşak veya Mekanik Salmastralı) SALYANGOZ KAPLINLİ POMPALAR

VOLUTE CASING LONG-COUPLED PUMPS (Soft Packing / Mechanical Seal)

TİP TYPE	Bağlantı Giriş x Çıkış Inlet x Outlet	MOTOR		m <sup>3</sup> /h	Debi (Q) - Capacity						Fiyat - Price (TL)		
		HP	kW		40	55	70	85	100	115	Tek Pompa	Şasi + Kaplin	Pompa + Mot Akuple Pump&Mot.coupled
BS-15	4" x 3"	15	11	Hm (mSS)	36	35	33	28	20		2,700 ₺	410 ₺	5,590 ₺
BS-20		20	15		47	46	44	40	34	26	2,700 ₺	450 ₺	6,370 ₺
BS-25		25	18.5		55	54	52	48	43	37	2,700 ₺	450 ₺	6,720 ₺
BS-30		30	22		65	64	62	58	53	46	2,700 ₺	450 ₺	7,470 ₺
BS-40		40	30		74	73	71	68	63	56	2,700 ₺	660 ₺	10,100 ₺
BS-50		50	37		88	87	85	82	78	70	2,700 ₺	660 ₺	11,200 ₺

Flanşlar hariçtir. Takım fiyatı (Flange Set): 160 TL

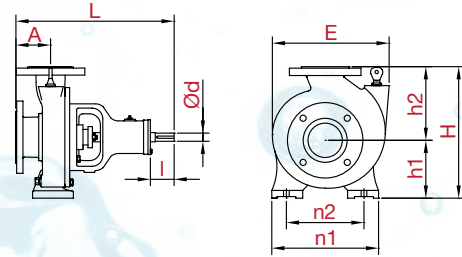
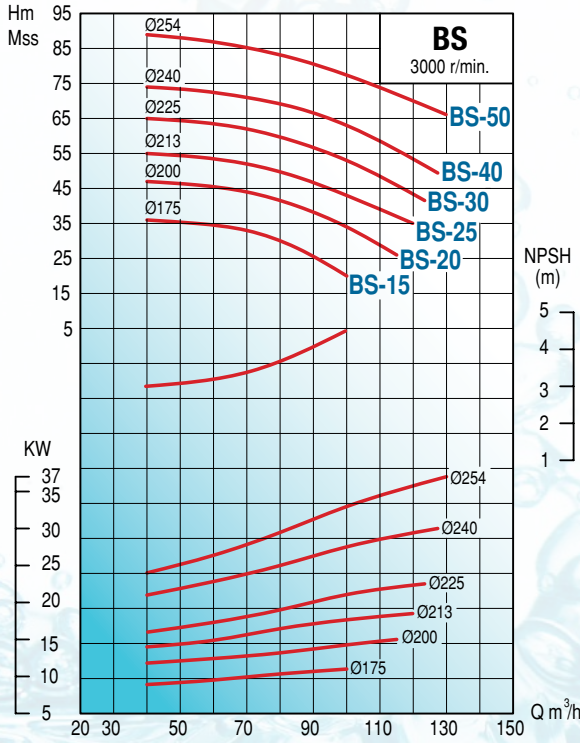

TİP TYPE	Boyutlar - Dimensions (mm)										Ağırlık - Weight
	A	L	h1	h2	H	E	n1	n2	I	d	Kg
BS	97	432	185	227	412	380	365	287	73	28	55

## AS (1500 d/d) (Yumuşak veya Mekanik Salmastralı) SALYANGOZ KAPLINLİ POMPALAR

**1500 d/d**

VOLUTE CASING LONG-COUPLED PUMPS (Soft Packing / Mechanical Seal)

TİP TYPE	Bağlantı Giriş x Çıkış Inlet x Outlet	MOTOR		m <sup>3</sup> /h	Debi (Q) - Capacity						Fiyat - Price (TL)		
		HP	kW		10	20	30	40	45	50	Tek Pompa	Şasi + Kaplin	Pompa + Mot Akuple Pump+Mot.coupled
AS-7.5 00754	3"x 2.5"	1	0,75		10	9	7	2			2,290 ₺	360 ₺	3,220 ₺
AS-10 01104		1,5	1,1		12	11	9	5			2,290 ₺	360 ₺	3,340 ₺
AS-15 01504		2	1,5		15	14	11,5	8	5,5		2,300 ₺	360 ₺	3,470 ₺
AS-20 02204		3	2,2		18	17	15	11,5	9	6	2,300 ₺	360 ₺	3,600 ₺

Flaşlar hariçtir. Takım fiyatı (Flange Set): 160 TL

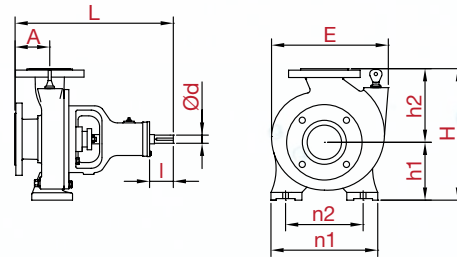
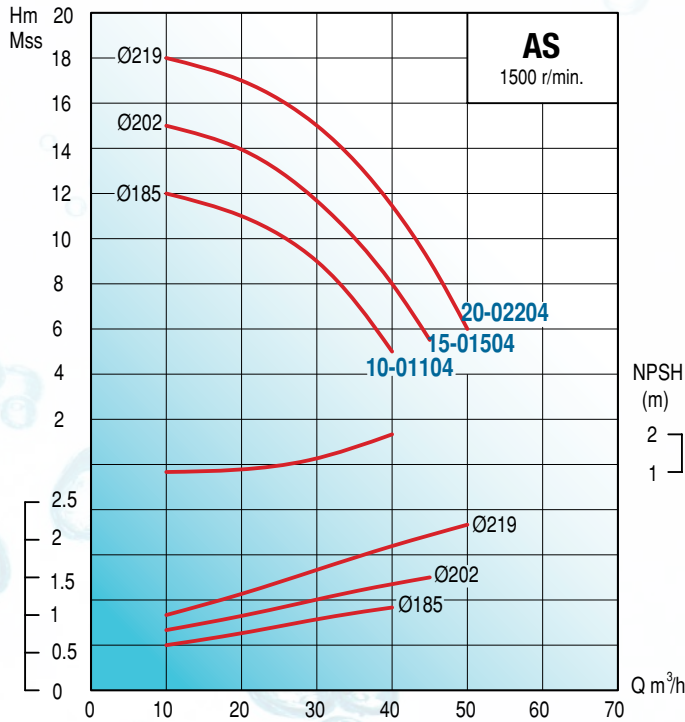

TİP TYPE	Boyutlar - Dimensions (mm)										Ağırlık - Weight
	A	L	h1	h2	H	E	n1	n2	I	d	Kg
AS	92	424	165	191	356	290	278	207	64	22	43

## BS (1500 d/d) (Yumuşak veya Mekanik Salmastralı) SALYANGOZ KAPLINLİ POMPALAR

**1500 d/d**

VOLUTE CASING LONG-COUPLED PUMPS (Soft Packing / Mechanical Seal)

TİP TYPE	Bağlantı Giriş x Çıkış Inlet x Outlet	MOTOR		Hm m(ss)	Debi (Q) - Capacity						Fiyat - Price (TL)		
		HP	kW		35	45	55	65	75	85	Tek Pompa	Şasi + Kaplin	Pompa + Mot Akuple Pump+Mot.coupled
	BS-30 03004	4" x 3"	4		3	15,5	15	14	12			2,700 ₺	370 ₺
BS-40 04004	5,5		4	18	17,5	16	14	11		2,730 ₺	520 ₺	4,490 ₺	
BS-50 05504	7,5		5,5	20	19,5	18	16	13,5	9,5	2,730 ₺	520 ₺	4,790 ₺	

Flanşlar hariçtir. Takım fiyatı (Flange Set): 160 TL

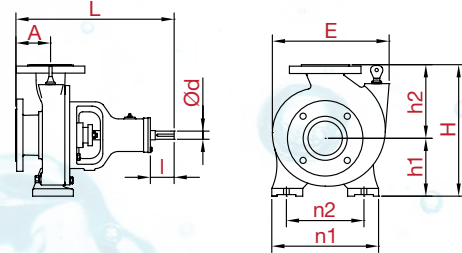
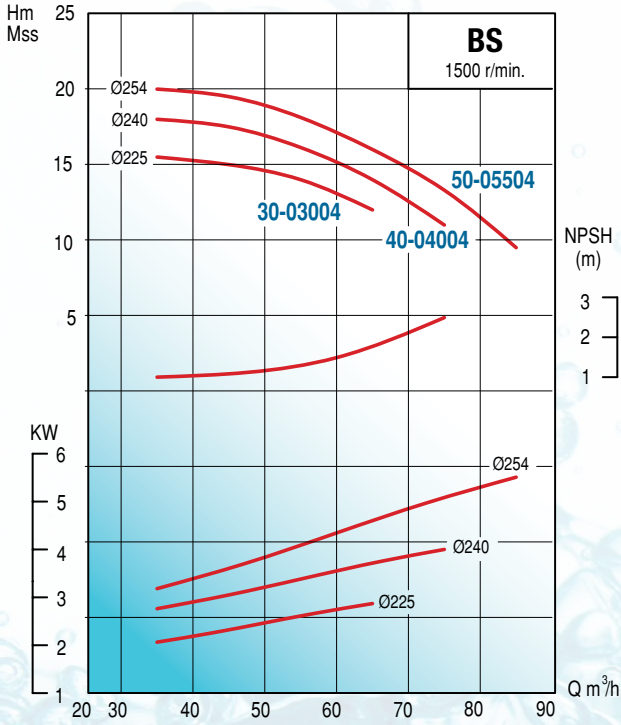

TİP TYPE	Boyutlar - Dimensions (mm)										Ağırlık - Weight	
	A	L	h1	h2	H	E	n1	n2	I	d	Kg	
BS	97	432	185	227	412	380	365	287	73	28	55	

**ES (3000 d/d & 1500 d/d) (TS EN 733)****SALYANGOZ KAPLINLI POMPALAR** (Yumuşak veya Mekanik Salmastralı)

VOLUTE CASING LONG-COUPLED PUMPS (Soft Packing / Mechanical Seal)

**TEKNİK ÖZELLİKLER**

- Kapasite: 10 - 320 m<sup>3</sup>/h
- Basma Yüksekliği: 9 - 156 m
- Devir Hızı: 1500 - 3000 d/d
- Sıvı Sıcaklığı: -10 °C ~ + 110 °C
- Giriş Flanşları: DN65 - DN125
- Çıkış Flanşları: DN 40 - DN100 (Flanşlar opsiyoneldir.)
- Yataklama: Mil yatağındaki 2 adet ağır hizmet tipi rulmanla sağlanır/ Gres yağlamalı (opsiyonel)
- Eksenel yük çark dengeleme delikleri ile dengelenir
- İzolasyon sınıfı: F
- Koruma sınıfı: IP55
- Emme derinliği: 6.5mt.

**MALZEME ÖZELLİKLERİ**

- Çark: PİK GG-25
- Emici ve Verici Gövde: PİK GG-25
- Mil: X20Cr13 (AISI420), Opsiyonel: AISI316 çelik
- Sızdırmazlık: Yumuşak veya Mekanik salmastra (Ca-Sic-Viton)
- Kaplin: Elastik
- Aşınma Halkası: GG-25 PİK Döküm

**KULLANIM ALANLARI**

- Temiz su temini
- Tarımsal sulama (Damlama ve Sprink sistemleri)
- Buhar kazanları besisi,
- Kondens sistemleri
- Endüstri ve inşaatlar
- Soğutma sistemleri
- Sirkülasyon
- Yangın söndürme

**OPSİYONEL**

- Açık Çark
- Bronz Çark
- AISI 316 / AISI 304 Çelik Mil

**TECHNICAL DATA**

- Capacity: 10 - 320 m<sup>3</sup>/h
- Total Head: 9 - 156
- Rotation Speed: 1500 - 3000 rpm
- Liquid Temp. : -10°C ~ +110°C
- Inlet Flanges: DN65 - DN125
- Outlet Flanges: DN40 - DN100 (Flanges are optional)
- Bearing: Pump Shaft is supported by 2 Heavy duty ball bearings on bearing housing / Grease lubricated (Optional)
- Axial load is reduced by balance holes
- Insulation Class: F
- Protection Class: IP55
- Suction lift: Max 6.5 m.

**MATERIAL SPECIFICATIONS**

- Impellers: Cast iron GG-25
- Inlet & Outlet Bodies: Cast iron GG-25
- Pump Shaft: X20Cr13 (AISI420) steel, Optional: AISI316 stainless steel.
- Non-Leakage: Soft packing / Mechanical seal (Ca-Sic-Viton)
- Coupling: Flexible
- Wear Ring: Cast iron GG-25

**APPLICATIONS**

- Clean water supply
- Irrigation (Drip and Sprinkler systems)
- Boiler feeding, condens systems
- Industrial plants, Constructions
- Chiller systems
- Circulation
- Fire fighting

**OPTIONAL**

- Open Impeller
- Bronze Impeller
- AISI 316 / AISI 304 S/S Shaft

## ES 40 (3000 d/d) (Yumuşak veya Mekanik Salmastralı) SALYANGOZ KAPLINLİ POMPALAR

VOLUTE CASING LONG-COUPLED PUMPS (Soft Packing / Mechanical Seal)

TİP TYPE	Bağlantı Giriş x Çıkış Inlet x Outlet	MOTOR			m <sup>3</sup> /h	Debi (Q) - Capacity						Fiyat - Price (TL)				
		HP	kW	V		380 / 660	Hm (mSS)	15	25	30	35	40	50	Tek Pompa	Şasi + Kaplin	Pompa + Mot Akuple Pump&Mot.coupled
ES 40-20 04002	2.5" x 1.5"	5,5	4	380	Hm (mSS)	37	20	5				2,530 ₺	410 ₺	4,130 ₺		
ES 40-20 05502		7,5	5,5			44	35	20	15				2,530 ₺	410 ₺	4,130 ₺	
ES 40-20 07502		10	7,5			45	42	39	35	30			2,530 ₺	410 ₺	4,610 ₺	
ES 40-20 11002		15	11			59	58	56	53	48	37		2,530 ₺	450 ₺	5,470 ₺	
ES 40-20 15002		20	15			66	65	63	60	56	45		2,530 ₺	600 ₺	6,350 ₺	

Flanşlar hariçtir. Takım fiyatı (Flange Set): 140 TL

TİP TYPE	Bağlantı Giriş x Çıkış Inlet x Outlet	MOTOR			m <sup>3</sup> /h	Debi (Q) - Capacity						Fiyat - Price (TL)				
		HP	kW	V		380 / 660	Hm (mSS)	10	20	30	40	50	60	Tek Pompa	Şasi + Kaplin	Pompa + Mot Akuple Pump&Mot.coupled
ES 40-26 15002	2.5" x 1.5"	20	15		Hm (mSS)	70	68	63	57	49		2,870 ₺	600 ₺	6,690 ₺		
ES 40-26 18502		25	18.5			78	76	72	66	59	51		2,870 ₺	600 ₺	7,040 ₺	
ES 40-26 22002		30	22			90	88	83	77	69	60		2,890 ₺	600 ₺	7,820 ₺	
ES 40-26 30002		40	30			98	97	93	87	80	71		2,890 ₺	670 ₺	10,280 ₺	

Flanşlar hariçtir. Takım fiyatı (Flange Set): 140 TL

TİP TYPE	Bağlantı Giriş x Çıkış Inlet x Outlet	MOTOR			m <sup>3</sup> /h	Debi (Q) - Capacity						Fiyat - Price (TL)				
		HP	kW	V		380 / 660	Hm (mSS)	15	20	30	35	40	50	Tek Pompa	Şasi + Kaplin	Pompa + Mot Akuple Pump&Mot.coupled
ES 40-32 22002	2.5" x 1.5"	30	22		Hm (mSS)	93	92	89	86	82		3,500 ₺	610 ₺	8,430 ₺		
ES 40-32 30002		40	30			105	103	99	97	94			3,500 ₺	670 ₺	10,880 ₺	
ES 40-32 37002		50	37			130	129	124	121	118	110		3,500 ₺	670 ₺	11,980 ₺	
ES 40-32 45002		60	45			143	142	137	134	131	123		3,520 ₺	740 ₺	13,380 ₺	
ES 40-32 55002		75	55			156	155	151	148	145	140		3,520 ₺	1,230 ₺	16,600 ₺	

Flanşlar hariçtir. Takım fiyatı (Flange Set): 140 TL



## ES 40 (3000 d/d) (Yumuşak veya Mekanik Salmastralı) SALYANGOZ KAPLINLİ POMPALAR

VOLUTE CASING LONG-COUPLED PUMPS (Soft Packing / Mechanical Seal)

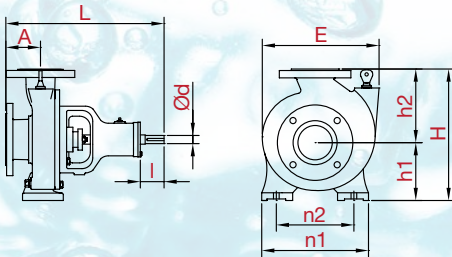
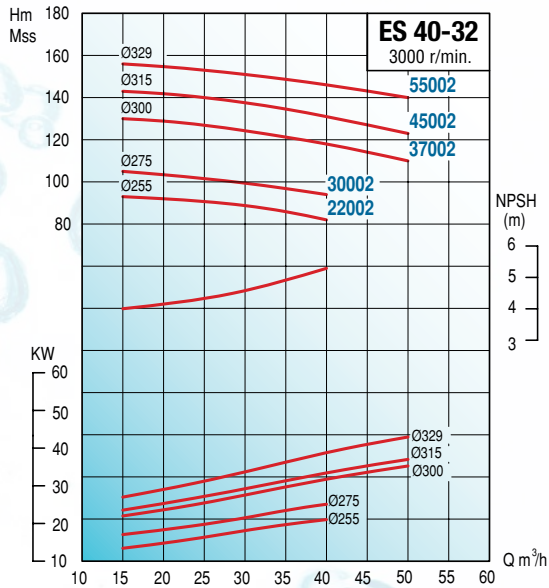
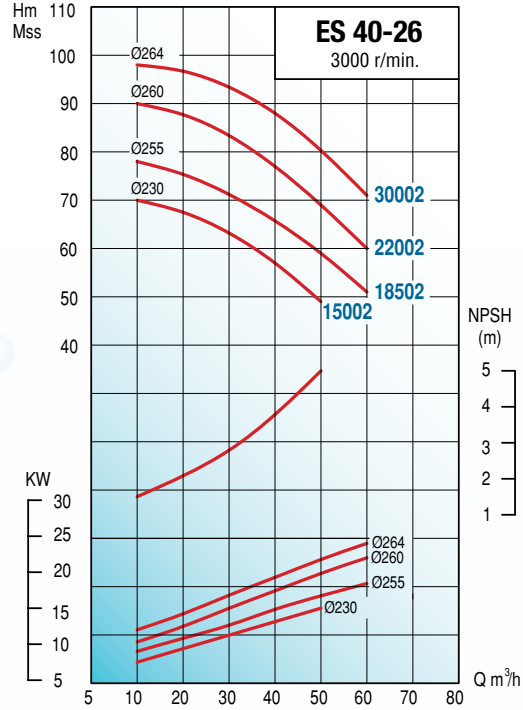
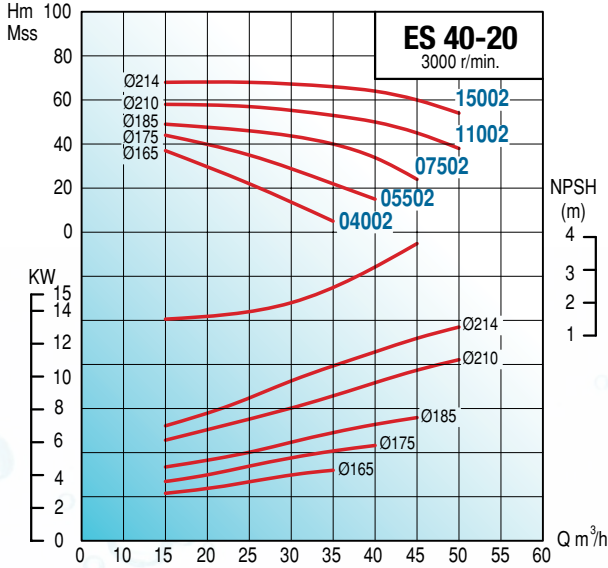

TİP TYPE	Boyutlar - Dimensions (mm)										Ağırlık - Weight Kg
	A	L	h1	h2	H	E	n1	n2	l	d	
ES 40-20	100	460	160	180	340	290	265	212	55	24	42
ES 40-26	100	460	180	225	405	340	320	250	55	24	59
ES 40-32	125	595	200	250	450	400	345	280	80	32	87



## ES 50 (3000 d/d) (Yumuşak veya Mekanik Salmastralı) **SALYANGOZ KAPLINLİ POMPALAR**

VOLUTE CASING LONG-COUPLED PUMPS (Soft Packing / Mechanical Seal)

TİP TYPE	Bağlantı Giriş x Çıkış Inlet x Outlet	MOTOR			m <sup>3</sup> /h	Debi (Q) - Capacity						Fiyat - Price (TL)			
		HP	kW	V		Hm (mSS)							Tek Pompa	Şasi + Kaplin	Pompa + Mot Akuple Pump&Mot.coupled
							30	40	50	60	70	80			
ES 50-20 11002	2.5" x 2"	15	11	380/660	Hm (mSS)	45	43	41	38	34		2,630 ₺	400 ₺	5,820 ₺	
ES 50-20 15002		20	15			54	52	49	46	42	38	2,630 ₺	450 ₺	6,720 ₺	
ES 50-20 18502		25	18.5			59	58	55	52	48	42	2,630 ₺	450 ₺	7,150 ₺	
ES 50-20 22002		30	22			64	63	61	58	54	48	2,630 ₺	450 ₺	7,400 ₺	

Flanşlar hariçtir. Takım fiyatı (Flange Set): 150 TL

TİP TYPE	Bağlantı Giriş x Çıkış Inlet x Outlet	MOTOR			m <sup>3</sup> /h	Debi (Q) - Capacity						Fiyat - Price (TL)			
		HP	kW	V		Hm (mSS)							Tek Pompa	Şasi + Kaplin	Pompa + Mot Akuple Pump&Mot.coupled
							30	40	55	70	85	105			
ES 50-26 18502	2.5" x 2"	25	18,5	380/660	Hm (mSS)	67	65	60	54	45		2,920 ₺	450 ₺	6,940 ₺	
ES 50-26 22002		30	22			75	73	68	62	53		2,920 ₺	450 ₺	7,700 ₺	
ES 50-26 30002		40	30			93	91	86	79	70	55		2,950 ₺	670 ₺	10,330 ₺
ES 50-26 37002		50	37			101	99	94	88	79	64		2,950 ₺	670 ₺	11,430 ₺

Flanşlar hariçtir. Takım fiyatı (Flange Set): 150 TL

TİP TYPE	Bağlantı Giriş x Çıkış Inlet x Outlet	MOTOR			m <sup>3</sup> /h	Debi (Q) - Capacity						Fiyat - Price (TL)			
		HP	kW	V		Hm (mSS)							Tek Pompa	Şasi + Kaplin	Pompa + Mot Akuple Pump&Mot.coupled
							30	45	60	75	90	105			
ES 50-32 30002	2.5" x 2"	40	30	380/660	Hm (mSS)	88	87	83	72	52		3,560 ₺	670 ₺	10,940 ₺	
ES 50-32 37002		50	37			99	98	95	87	68		3,560 ₺	670 ₺	12,040 ₺	
ES 50-32 45002		60	45			112	111	107	99	84	52		3,590 ₺	740 ₺	13,450 ₺
ES 50-32 55002		75	55			135	134	131	125	112	90		3,590 ₺	1,230 ₺	16,670 ₺
ES 50-32 75002		100	75			147	146	144	138	128	112		3,610 ₺	1,470 ₺	20,660 ₺

Flanşlar hariçtir. Takım fiyatı (Flange Set): 150 TL



## ES 50 (3000 d/d) (Yumuşak veya Mekanik Salmastralı) SALYANGOZ KAPLINLİ POMPALAR

VOLUTE CASING LONG-COUPLED PUMPS (Soft Packing / Mechanical Seal)

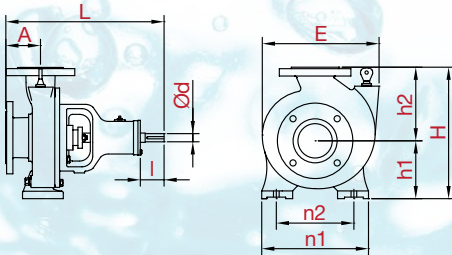
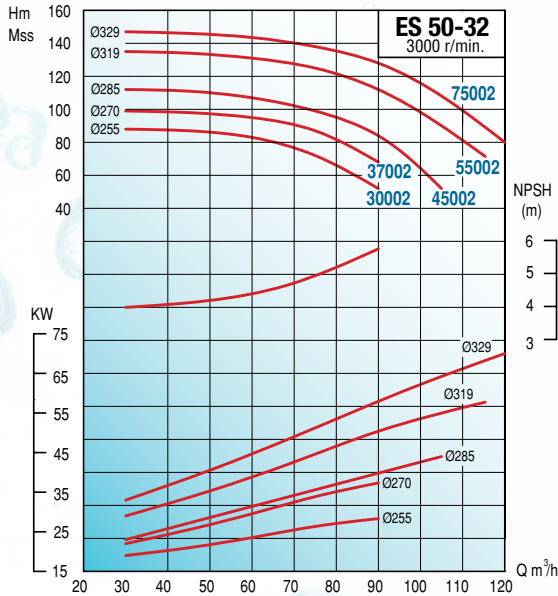
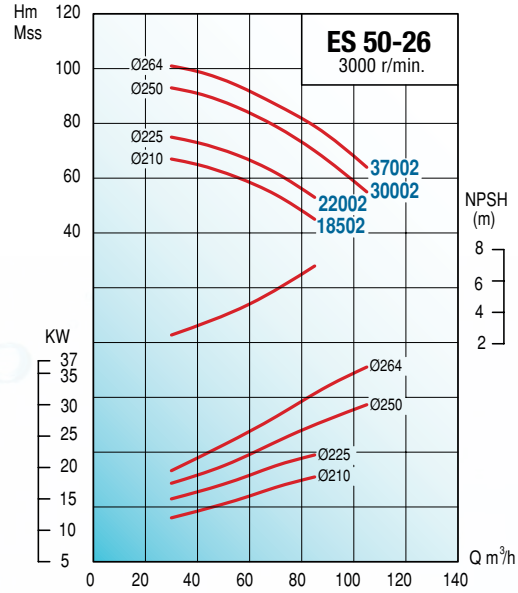
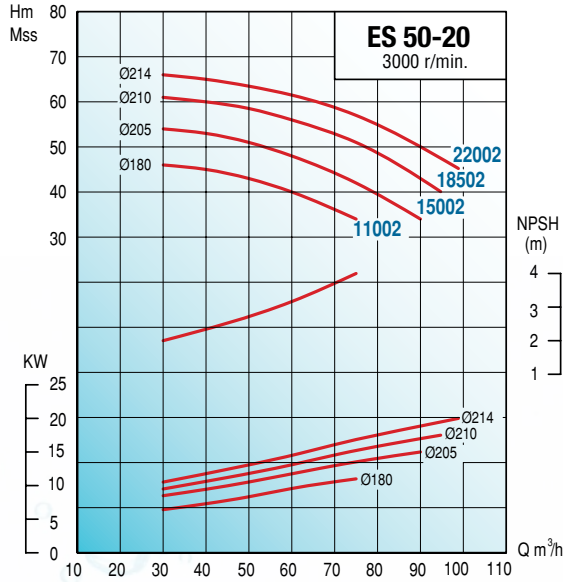

TİP TYPE	Boyutlar - Dimensions (mm)										Ağırlık - Weight
	A	L	h1	h2	H	E	n1	n2	I	d	Kg
ES 50-20	100	460	160	200	360	305	265	212	55	24	47
ES 50-26	100	460	180	225	405	335	320	250	55	24	62
ES 50-32	125	595	225	280	507	417	345	280	80	32	90

## ES 65 (3000 d/d) (Yumuşak veya Mekanik Salmastralı) SALYANGOZ KAPLINLİ POMPALAR

VOLUTE CASING LONG-COUPLED PUMPS (Soft Packing / Mechanical Seal)

TİP TYPE	Bağlantı Giriş x Çıkış Inlet x Outlet	MOTOR			m <sup>3</sup> /h	Debi (Q) - Capacity						Fiyat - Price (TL)			
		HP	kW	V		Hm (mSS)	30	60	90	110	125	140	Tek Pompa	Şasi + Kaplin	Pompa + Mot Akuple Pump&Mot.coupled
ES 65-16 07502	3" x 2.5"	10	7,5	380/660	Hm (mSS)	30	26	18	13	7		2,650 ₺	370 ₺	4,680 ₺	
ES 65-16 11002		15	11			36	33	26	22	17	5	2,650 ₺	410 ₺	5,540 ₺	
ES 65-16 15002		20	15			42	38	33	27	22	16	2,650 ₺	600 ₺	6,470 ₺	

Flanşlar hariçtir. Takım fiyatı (Flange Set): 160 TL

TİP TYPE	Bağlantı Giriş x Çıkış Inlet x Outlet	MOTOR			m <sup>3</sup> /h	Debi (Q) - Capacity						Fiyat - Price (TL)			
		HP	kW	V		Hm (mSS)	80	100	125	140	150	155	Tek Pompa	Şasi + Kaplin	Pompa + Mot Akuple Pump&Mot.coupled
ES 65-20 15002	3" x 2.5"	20	15	380 / 660	Hm (mSS)	29	26	20	14	6		2,760 ₺	450 ₺	6,440 ₺	
ES 65-20 18502		25	18.5			34	31	26	20	15	5	2,760 ₺	450 ₺	6,780 ₺	
ES 65-20 22002		30	22			39	36	30	25	20	9	2,760 ₺	450 ₺	7,540 ₺	
ES 65-20 30002		40	30			45	42	36	30	24	14	2,760 ₺	660 ₺	10,140 ₺	

Flanşlar hariçtir. Takım fiyatı (Flange Set): 160 TL

TİP TYPE	Bağlantı Giriş x Çıkış Inlet x Outlet	MOTOR			m <sup>3</sup> /h	Debi (Q) - Capacity						Fiyat - Price (TL)			
		HP	kW	V		Hm (mSS)	30	50	125	150	155	160	Tek Pompa	Şasi + Kaplin	Pompa + Mot Akuple Pump&Mot.coupled
ES 65-26 22002	3" x 2.5"	30	22	380 / 660	Hm (mSS)	59	58	43	25	17	2	3,260 ₺	610 ₺	8,190 ₺	
ES 65-26 30002		40	30			65	64	52	39	32	12	3,280 ₺	670 ₺	10,670 ₺	
ES 65-26 37002		50	37			81	80	67	55	50	40	3,280 ₺	670 ₺	11,760 ₺	
ES 65-26 45002		60	45			91	90	88	72	66	60	3,340 ₺	740 ₺	13,200 ₺	
ES 65-26 55002		75	55			99	98	90	80	76	70	3,340 ₺	1,360 ₺	16,550 ₺	

Flanşlar hariçtir. Takım fiyatı (Flange Set): 160 TL

TİP TYPE	Bağlantı Giriş x Çıkış Inlet x Outlet	MOTOR			m <sup>3</sup> /h	Debi (Q) - Capacity						Fiyat - Price (TL)			
		HP	kW	V		Hm (mSS)	90	125	145	150	155	160	Tek Pompa	Şasi + Kaplin	Pompa + Mot Akuple Pump&Mot.coupled
ES 65-32 45002	3" x 2.5"	60	45	380/660	Hm (mSS)	81	75	60	54	44	11	3,860 ₺	740 ₺	13,720 ₺	
ES 65-32 55002		75	55			95	88	70	63	54	43	3,860 ₺	1,230 ₺	16,940 ₺	
ES 65-32 75002		100	75			120	106	80	70	60	47	3,888 ₺	1,470 ₺	20,930 ₺	
ES 65-32 90002		125	90			132	120	106	100	90	85	3,888 ₺	1,470 ₺	25,040 ₺	

Flanşlar hariçtir. Takım fiyatı (Flange Set): 160 TL



## ES 65 (3000 d/d) (Yumuşak veya Mekanik Salmastralı) SALYANGOZ KAPLINLİ POMPALAR

VOLUTE CASING LONG-COUPLED PUMPS (Soft Packing / Mechanical Seal)

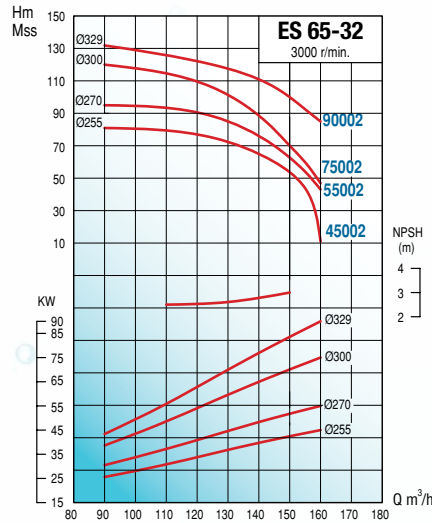
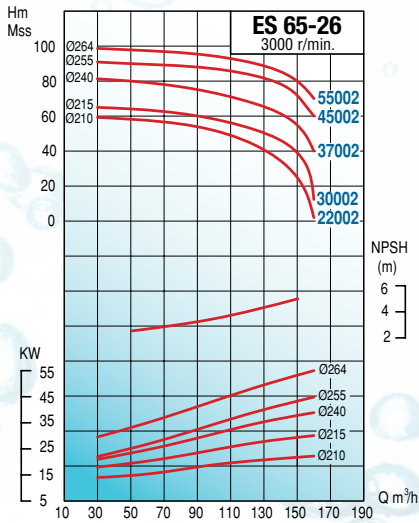
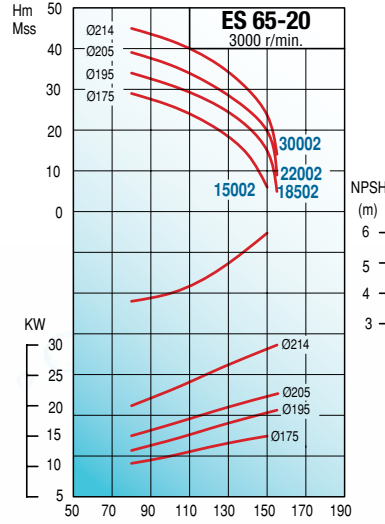
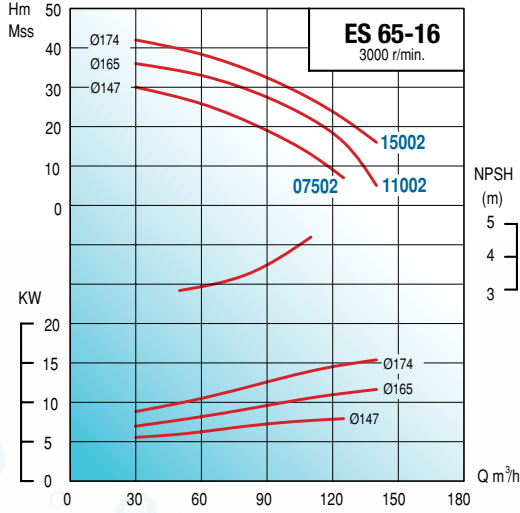

TİP TYPE	Boyutlar - Dimensions (mm)										Ağırlık - Weight
	A	L	h1	h2	H	E	n1	n2	l	d	Kg
ES 65-16	100	460	160	180	340	285	280	212	50	24	47
ES 65-20	100	460	180	225	405	335	320	250	55	24	52
ES 65-26	100	570	200	250	450	375	360	280	84	32	81
ES 65-32	125	595	225	280	505	415	400	315	84	32	106

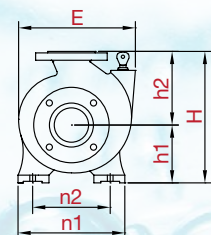
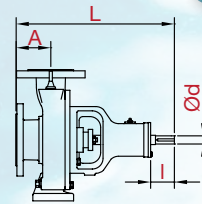

## ES 80 (3000 d/d) (Yumuşak veya Mekanik Salmastralı) **SALYANGOZ KAPLINLİ POMPALAR**

VOLUTE CASING LONG-COUPLED PUMPS (Soft Packing / Mechanical Seal)

TİP TYPE	Bağlantı Giriş x Çıkış Inlet x Outlet	MOTOR			m <sup>3</sup> /h	Debi (Q) - Capacity						Fiyat - Price (TL)		
		HP	kW	V								Tek Pompa Bare Pump	Şasi + Kaplin	Pompa + Mot Akuple Pump&Mot.coupled
						70	100	130	160	190	220			
ES 80-16 11002	4"x3"	15	11	380/660	Hm(mSS)	26	25	23	19	13		2,720 ₺	410 ₺	5,610 ₺
ES 80-16 15002		20	15			30	29	28	25	20	13	2,720 ₺	600 ₺	6,540 ₺
ES 80-16 18502		25	18,5			34	33	32	29	25	18	2,720 ₺	600 ₺	6,890 ₺
ES 80-16 22002		30	22			38	37	36	33	29	23	2,720 ₺	600 ₺	7,640 ₺

Flanşlar hariçtir. Takım fiyatı (Flange Set): 160 TL

TİP TYPE	Bağlantı Giriş x Çıkış Inlet x Outlet	MOTOR			m <sup>3</sup> /h	Debi (Q) - Capacity						Fiyat - Price (TL)		
		HP	kW	V								Tek Pompa Bare Pump	Şasi + Kaplin	Pompa + Mot Akuple Pump&Mot.coupled
						90	120	150	180	210	240			
ES 80-20 18502	4" x 3"	25	18,5	380 / 660	Hm (mSS)	41	39	35	29	20		3,050 ₺	610 ₺	7,230 ₺
ES 80-20 22002		30	22			47	46	44	40	33		3,050 ₺	610 ₺	7,990 ₺
ES 80-20 30002		40	30			53	52	50	46	40	32	3,080 ₺	670 ₺	10,460 ₺
ES 80-20 37002		50	37			58	57	55	52	47	40	3,080 ₺	670 ₺	11,560 ₺
ES 80-20 45002		60	45			64	63	62	59	54	46	3,110 ₺	740 ₺	12,970 ₺

Flanşlar hariçtir. Takım fiyatı (Flange Set): 160 TL

TİP TYPE	Bağlantı Giriş x Çıkış Inlet x Outlet	MOTOR			m <sup>3</sup> /h	Debi (Q) - Capacity						Fiyat - Price (TL)		
		HP	kW	V								Tek Pompa Bare Pump	Şasi + Kaplin	Pompa + Mot Akuple Pump&Mot.coupled
						70	100	130	160	190	220			
ES 80-26 30002	4" x 3"	40	30	380 / 660	Hm (mSS)	59	58	55	50	41		3,510 ₺	670 ₺	10,890 ₺
ES 80-26 37002		50	37			64	63	61	57	49		3,510 ₺	670 ₺	11,990 ₺
ES 80-26 45002		60	45			70	69	67	63	57	48	3,530 ₺	740 ₺	13,390 ₺
ES 80-26 55002		75	55			81	80	78	74	68	60	3,530 ₺	1,230 ₺	16,620 ₺
ES 80-26 75002		100	75			99	98	95	91	86	80	3,560 ₺	1,470 ₺	20,600 ₺

Flanşlar hariçtir. Takım fiyatı (Flange Set): 160 TL

TİP TYPE	Bağlantı Giriş x Çıkış Inlet x Outlet	MOTOR			m <sup>3</sup> /h	Debi (Q) - Capacity						Fiyat - Price (TL)		
		HP	kW	V								Tek Pompa Bare Pump	Şasi + Kaplin	Pompa + Mot Akuple Pump&Mot.coupled
						80	120	160	180	200	240			
ES 80-32 75002	4" x 3"	100	75	380 / 660	Hm (mSS)	95	94	92	89	86	74	3,780 ₺	1,470 ₺	20,820 ₺
ES 80-32 90002		125	90			109	106	104	102	100	92	3,780 ₺	1,470 ₺	24,930 ₺

Flanşlar hariçtir. Takım fiyatı (Flange Set): 160 TL





## ES 80 (3000 d/d) (Yumuşak veya Mekanik Salmastralı) SALYANGOZ KAPLINLI POMPALAR

VOLUTE CASING LONG-COUPLED PUMPS (Soft Packing / Mechanical Seal)

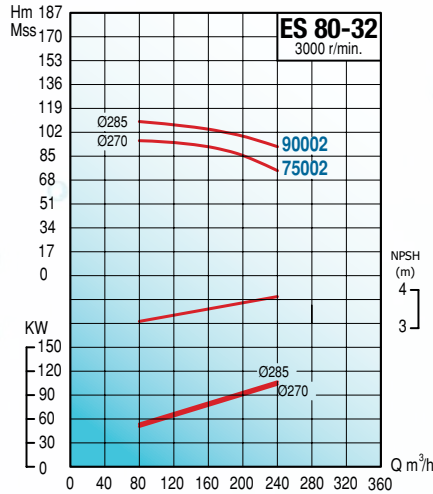
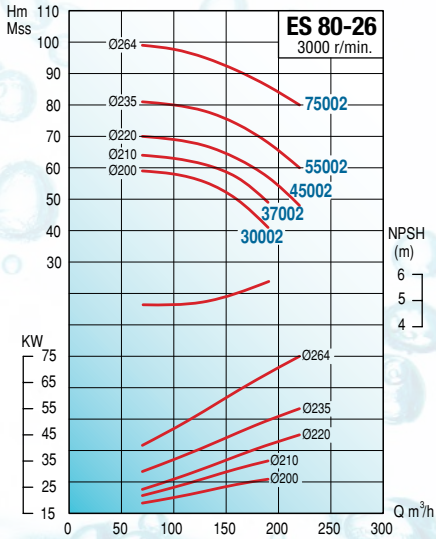
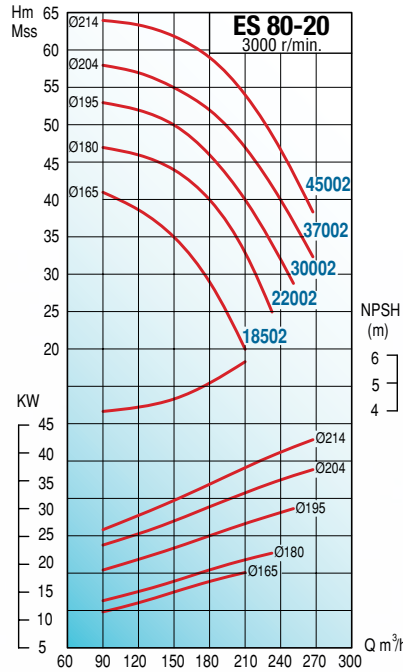
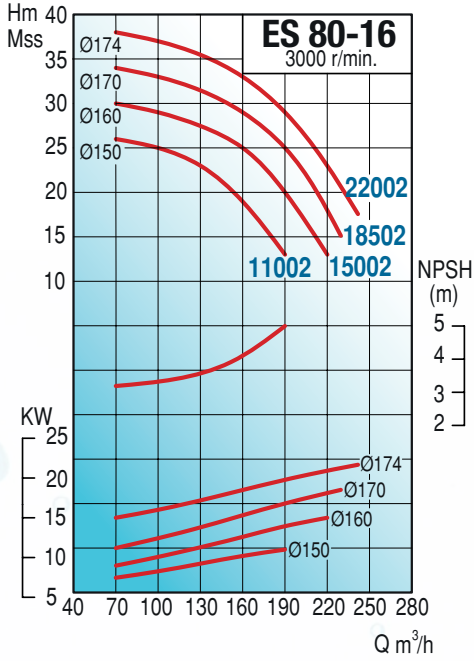

TİP TYPE	Boyutlar - Dimensions (mm)										Ağırlık - Weight
	A	L	h1	h2	H	E	n1	n2	l	d	Kg
ES 80-16	125	485	180	225	405	350	320	250	50	24	51
ES 80-20	125	595	180	250	430	385	345	280	84	32	65
ES 80-26	125	595	200	280	480	420	400	315	84	32	86
ES 80-32	125	595	250	315	565	445	400	315	84	32	92

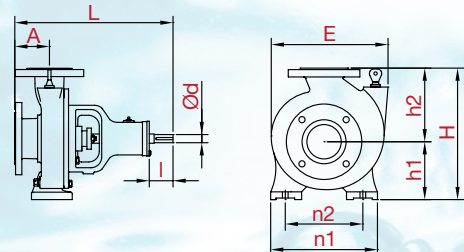

## ES 100 (3000 d/d) (Yumuşak veya Mekanik Salmastralı) SALYANGOZ KAPLINLI POMPALAR

VOLUTE CASING LONG-COUPLED PUMPS (Soft Packing / Mechanical Seal)

TİP TYPE	Bağlantı Giriş x Çıkış Inlet x Outlet	MOTOR			m <sup>3</sup> /h	Debi (Q) - Capacity						Fiyat - Price (TL)			
		HP	kW	V		Hm (mSS)	120	160	200	240	280	320	Tek Pompa	Şasi + Kaplin	Pompa + Mot Akuple Pump&Mot.coupled
ES 100-20 30002	5" x 4"	40	30	380 / 660	Hm (mSS)	43	41	38	35	30		3,300 ₺	670 ₺	10,690 ₺	
ES 100-20 37002		50	37			49	47	44	41	36	30	3,300 ₺	670 ₺	11,780 ₺	
ES 100-20 45002		60	45			55	53	51	47	42	35	3,330 ₺	740 ₺	13,190 ₺	
ES 100-20 55002		75	55			63	61	58	54	50	44	3,330 ₺	1,230 ₺	16,410 ₺	

Flanşlar hariçtir. Takım fiyatı (Flange Set): 180 TL

TİP TYPE	Bağlantı Giriş x Çıkış Inlet x Outlet	MOTOR			m <sup>3</sup> /h	Debi (Q) - Capacity						Fiyat - Price (TL)			
		HP	kW	V		Hm (mSS)	70	160	200	240	280	320	Tek Pompa	Şasi + Kaplin	Pompa + Mot Akuple Pump&Mot.coupled
ES 100-26 55002	5" x 4"	75	55	380 / 660	Hm (mSS)	68	67	63	56	44		3,700 ₺	1,230 ₺	16,790 ₺	
ES 100-26 75002		100	75			81	80	77	72	64	52	3,730 ₺	1,470 ₺	20,770 ₺	
ES 100-26 90002		125	90			100	98	97	95	93	90	3,730 ₺	1,470 ₺	24,890 ₺	

Flanşlar hariçtir. Takım fiyatı (Flange Set): 180 TL

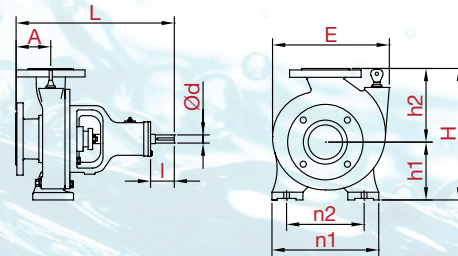
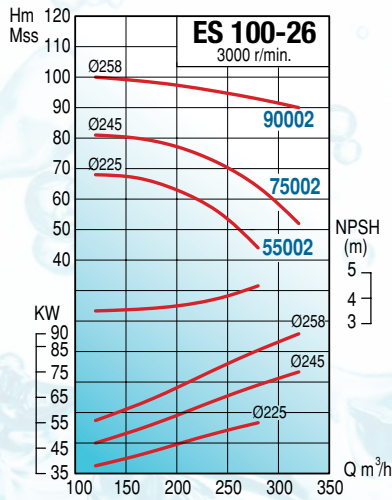
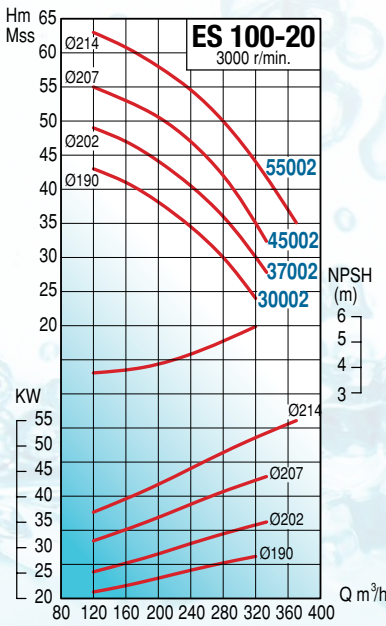

TİP TYPE	Boyutlar - Dimensions (mm)										Ağırlık - Weight Kg
	A	L	h1	h2	H	E	n1	n2	l	d	
ES 100-20	125	595	200	280	480	385	360	280	84	32	75
ES 100-26	140	610	225	280	505	420	400	315	84	32	96

## ES 40 (1500 d/d) (Yumuşak veya Mekanik Salmastralı) SALYANGOZ KAPLINLİ POMPALAR

**1500 d/d**

VOLUTE CASING LONG-COUPLED PUMPS (Soft Packing / Mechanical Seal)

TİP TYPE	Bağlantı Giriş x Çıkış Inlet x Outlet	MOTOR			m <sup>3</sup> /h	Debi (Q) - Capacity						Fiyat - Price (TL)			
		HP	kW	V		Hm (mSS)	8	12	14	16	18	20	Tek Pompa	Şasi + Kaplin	Pompa + Mot Akuple Pump&Mot.coupled
ES 40-20 00754	2.5" x 1.5"	1	0.75	380	Hm (mSS)	10	9.5	9	8	7		2,630 ₺	300 ₺	3,500 ₺	
ES 40-20 01104		1.5	1.1			13.5	13	12.5	11.5	10.5	9	2,630 ₺	300 ₺	3,620 ₺	
ES 40-20 01504		2	1.5			16	15.5	15	14	13	11.5	2,630 ₺	300 ₺	3,730 ₺	

Flanşlar hariçtir. Takım fiyatı (Flange Set): 140 TL

TİP TYPE	Bağlantı Giriş x Çıkış Inlet x Outlet	MOTOR			m <sup>3</sup> /h	Debi (Q) - Capacity						Fiyat - Price (TL)			
		HP	kW	V		Hm (mSS)	9	12	15	18	23	25	Tek Pompa	Şasi + Kaplin	Pompa + Mot Akuple Pump&Mot.coupled
ES 40-26 01104	2.5" x 1.5"	1.5	1.1	380	Hm (mSS)	12	11.5	11	10			2,840 ₺	370 ₺	3,900 ₺	
ES 40-26 01504		2	1.5			16	15	14.5	13.5	11		2,840 ₺	370 ₺	4,010 ₺	
ES 40-26 02204		3	2.2			20	19.5	19	18	15.5		2,840 ₺	370 ₺	4,150 ₺	
ES 40-26 03004		4	3			24.5	24	23.5	22.5	19.5	18	2,840 ₺	370 ₺	4,240 ₺	

Flanşlar hariçtir. Takım fiyatı (Flange Set): 140 TL

TİP TYPE	Bağlantı Giriş x Çıkış Inlet x Outlet	MOTOR			m <sup>3</sup> /h	Debi (Q) - Capacity						Fiyat - Price (TL)			
		HP	kW	V		Hm (mSS)	10	14	18	22	26	30	Tek Pompa	Şasi + Kaplin	Pompa + Mot Akuple Pump&Mot.coupled
ES 40-32 02204	2.5" x 1.5"	3	2.2	380/660	Hm (mSS)	20	19	17	14			3,470 ₺	370 ₺	4,780 ₺	
ES 40-32 03004		4	3			26	25	23	20.5	16		3,470 ₺	370 ₺	4,870 ₺	
ES 40-32 04004		5.5	4			31	30	28.5	26	23	17	3,470 ₺	370 ₺	5,080 ₺	
ES 40-32 05504		7.5	5.5			38	37	35	32	28	23	3,470 ₺	370 ₺	5,380 ₺	

Flanşlar hariçtir. Takım fiyatı (Flange Set): 140 TL





## ES 40 (1500 d/d) (Yumuşak veya Mekanik Salmastralı) SALYANGOZ KAPLINLİ POMPALAR

**1500 d/d**

VOLUTE CASING LONG-COUPLED PUMPS (Soft Packing / Mechanical Seal)

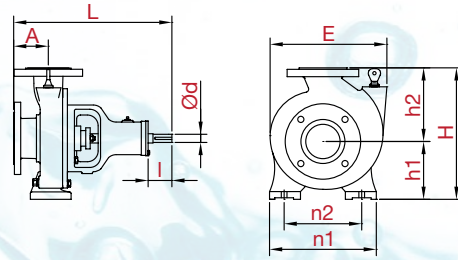
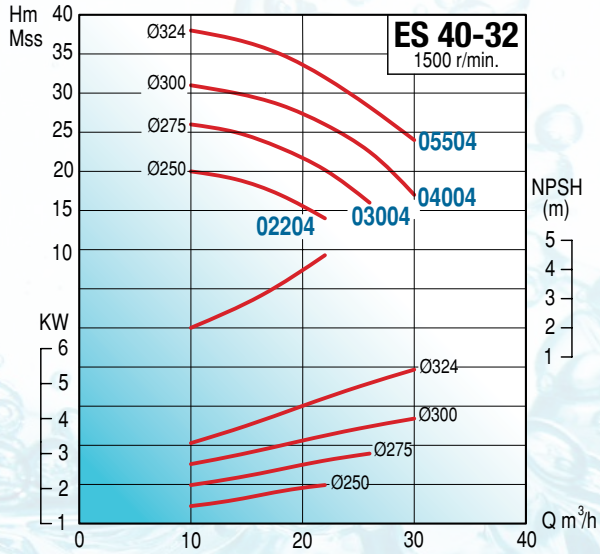
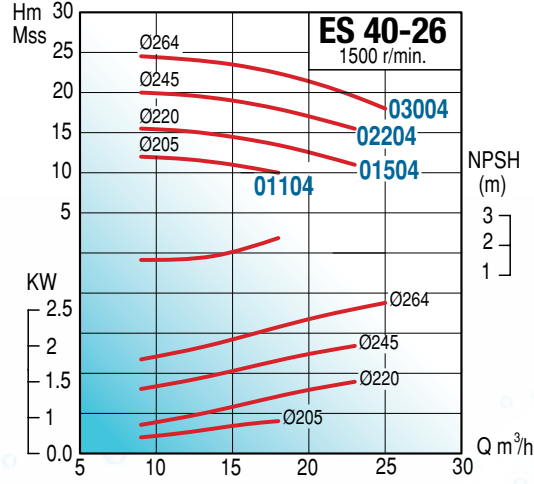
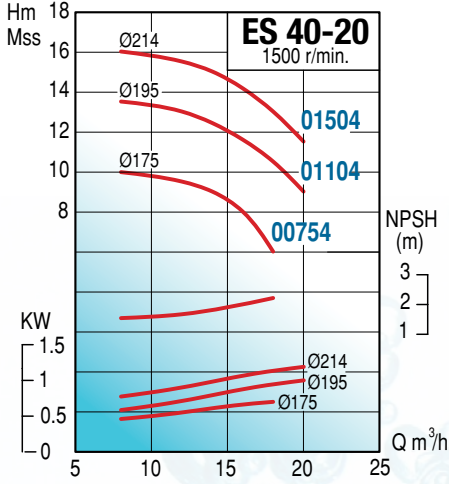

TİP TYPE	Boyutlar - Dimensions (mm)										Ağırlık - Weight
	A	L	h1	h2	H	E	n1	n2	I	d	Kg
ES 40-20	100	460	160	180	340	290	265	212	55	24	42
ES 40-26	100	460	180	225	405	340	320	250	55	24	59
ES 40-32	125	595	200	250	450	405	345	280	65	32	89

## ES 50 (1500 d/d) (Yumuşak veya Mekanik Salmastralı) SALYANGOZ KAPLINLİ POMPALAR

**1500 d/d**

VOLUTE CASING LONG-COUPLED PUMPS (Soft Packing / Mechanical Seal)

TİP TYPE	Bağlantı Giriş x Çıkış Inlet x Outlet	MOTOR			m <sup>3</sup> /h	Debi (Q) - Capacity						Fiyat - Price (TL)				
		HP	kW	V		Hm (mSS)	15	20	25	30	35	40	Tek Pompa	Şasi + Kaplin	Pompa + Mot Akuple Pomp&Mot.coupled	
							380	10.5	10	9	8					
ES 50-20 01104	2.5" x 2"	1.5	1.1	380	Hm (mSS)	10.5	10	9	8			2,600 ₺	360 ₺	3,660 ₺		
ES 50-20 01504		2	1.5			12.5	12.2	11.5	10.5	9.5			2,600 ₺	360 ₺	3,770 ₺	
ES 50-20 02204		3	2.2			15	14.5	14	13.5	12.5	11			2,600 ₺	360 ₺	3,910 ₺
ES 50-20 03004		4	3			16.5	16	15.5	15	14	12.5			2,600 ₺	360 ₺	4,000 ₺

Flanşlar hariçtir. Takım fiyatı (Flange Set): 150 TL

TİP TYPE	Bağlantı Giriş x Çıkış Inlet x Outlet	MOTOR			m <sup>3</sup> /h	Debi (Q) - Capacity						Fiyat - Price (TL)				
		HP	kW	V		Hm (mSS)	15	25	30	35	40	50	Tek Pompa	Şasi + Kaplin	Pompa + Mot Akuple Pomp&Mot.coupled	
							380/ 660	15,5	14,5	13	11					
ES 50-26 02204	2.5" x 2"	3	2,2	380/ 660	Hm (mSS)	15,5	14,5	13	11			2,920 ₺	360 ₺	4,220 ₺		
ES 50-26 03004		4	3			19,5	19	18	16,5	14,5			2,920 ₺	360 ₺	4,320 ₺	
ES 50-26 04004		5,5	4			22,5	22	21,5	21	20	17			2,920 ₺	360 ₺	4,530 ₺
ES 50-26 05504		7,5	5,5			24,5	24	23,5	23	22	19			2,920 ₺	360 ₺	4,830 ₺

Flanşlar hariçtir. Takım fiyatı (Flange Set): 150 TL

TİP TYPE	Bağlantı Giriş x Çıkış Inlet x Outlet	MOTOR			m <sup>3</sup> /h	Debi (Q) - Capacity						Fiyat - Price (TL)				
		HP	kW	V		Hm (mSS)	15	25	35	45	55	65	Tek Pompa	Şasi + Kaplin	Pompa + Mot Akuple Pomp&Mot.coupled	
							380 / 660	25	24	22	19,5	16				
ES 50-32 04004	2.5" x 2"	5,5	4	380 / 660	Hm (mSS)	25	24	22	19,5	16		3,530 ₺	370 ₺	5,140 ₺		
ES 50-32 05504		7,5	5,5			29	28	26,5	24	21			3,530 ₺	370 ₺	5,450 ₺	
ES 50-32 07504		10	7,5			34	33	31	29	26	22			3,530 ₺	370 ₺	5,870 ₺
ES 50-32 11004		15	11			37	36	34,5	32	29,5	25			3,530 ₺	410 ₺	6,730 ₺

Flanşlar hariçtir. Takım fiyatı (Flange Set): 150 TL



## ES 50 (1500 d/d) (Yumuşak veya Mekanik Salmastralı) SALYANGOZ KAPLINLİ POMPALAR

**1500 d/d**

VOLUTE CASING LONG-COUPLED PUMPS (Soft Packing / Mechanical Seal)

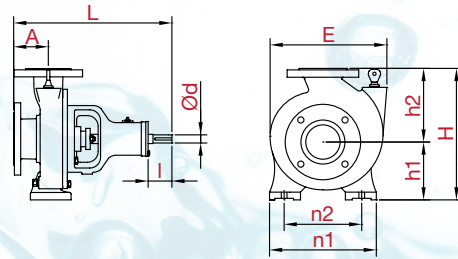
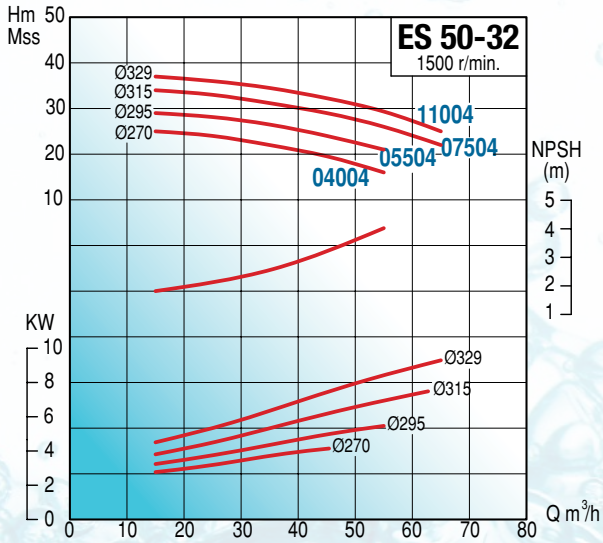
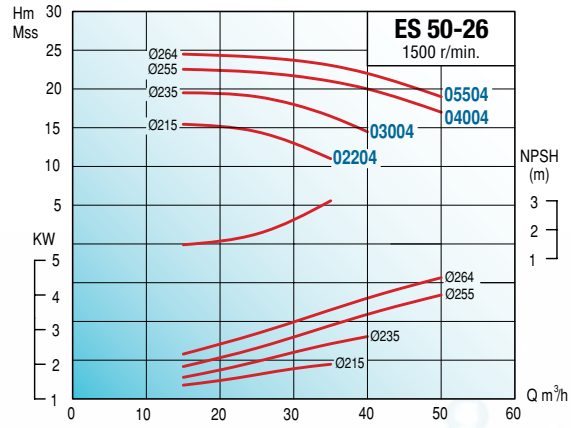
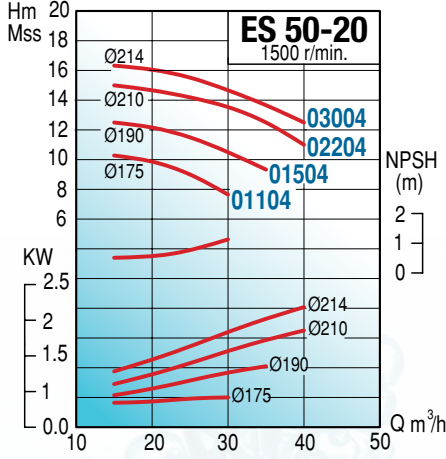

TİP TYPE	Boyutlar - Dimensions (mm)										Ağırlık - Weight
	A	L	h1	h2	H	E	n1	n2	I	d	Kg
ES 50-20	100	460	160	200	360	305	265	212	55	24	47
ES 50-26	100	460	180	225	405	335	320	250	55	24	62
ES 50-32	125	595	225	280	507	415	345	280	65	32	92

## ES 65 (1500 d/d) (Yumuşak veya Mekanik Salmastralı) SALYANGOZ KAPLINLİ POMPALAR

**1500 d/d**

VOLUTE CASING LONG-COUPLED PUMPS (Soft Packing / Mechanical Seal)

TİP TYPE	Bağlantı Giriş x Çıkış Inlet x Outlet	MOTOR			m <sup>3</sup> /h	Debi (Q) - Capacity						Fiyat - Price (TL)			
		HP	kW	V		Hm (mSS)	10	20	30	40	50	60	Tek Pompa Bare Pump	Şasi + Kaplin	Pompa + Mot Akuple Pump&Mot.coupled
ES 65-16 01104	3"x2.5"	1,5	1,1	380	Hm (mSS)	8	7,5	7	6	4		2,650 ₺	300 ₺	3,640 ₺	
ES 65-16 01504		2	1,5			9	8,5	8	7,5	6	4	2,650 ₺	300 ₺	3,750 ₺	
ES 65-16 02204		3	2,2			11,5	11	10,5	10	9	8	2,650 ₺	300 ₺	3,890 ₺	

Flanşlar hariçtir. Takım fiyatı (Flange Set): 160 TL

TİP TYPE	Bağlantı Giriş x Çıkış Inlet x Outlet	MOTOR			m <sup>3</sup> /h	Debi (Q) - Capacity						Fiyat - Price (TL)			
		HP	kW	V		Hm (mSS)	15	30	45	60	75	90	Tek Pompa Bare Pump	Şasi + Kaplin	Pompa + Mot Akuple Pump&Mot.coupled
ES 65-20 01504	3" x 2.5"	2	1.5	380	Hm (mSS)	9	8.5	7	5			2,740 ₺	360 ₺	3,900 ₺	
ES 65-20 02204		3	2.2			11	10.5	9.5	7.5			2,740 ₺	360 ₺	4,040 ₺	
ES 65-20 03004		4	3			14	13.5	12.5	11	8.5			2,740 ₺	360 ₺	4,130 ₺
ES 65-20 04004		5.5	4			16	15.5	14.5	13	11	8		2,740 ₺	360 ₺	4,340 ₺

Flanşlar hariçtir. Takım fiyatı (Flange Set): 160 TL

TİP TYPE	Bağlantı Giriş x Çıkış Inlet x Outlet	MOTOR			m <sup>3</sup> /h	Debi (Q) - Capacity						Fiyat - Price (TL)				
		HP	kW	V		Hm (mSS)	20	35	45	55	65	75	Tek Pompa Bare Pump	Şasi + Kaplin	Pompa + Mot Akuple Pump&Mot.coupled	
ES 65-26 03004	3" x 2.5"	4	3	380	Hm (mSS)	16	15.5	14.5	12.5			3,260 ₺	370 ₺	4,660 ₺		
ES 65-26 04004		5.5	4			19.5	19	17.5	16	14			3,260 ₺	370 ₺	4,870 ₺	
ES 65-26 05504		7.5	5.5			22.5	22	21	20	19	17.5			3,260 ₺	370 ₺	5,170 ₺
ES 65-26 07504		10	7.5			25	24.5	24	23	22	20			3,260 ₺	370 ₺	5,590 ₺

Flanşlar hariçtir. Takım fiyatı (Flange Set): 160 TL

TİP TYPE	Bağlantı Giriş x Çıkış Inlet x Outlet	MOTOR			m <sup>3</sup> /h	Debi (Q) - Capacity						Fiyat - Price (TL)				
		HP	kW	V		Hm (mSS)	30	45	60	75	90	105	Tek Pompa Bare Pump	Şasi + Kaplin	Pompa + Mot Akuple Pump&Mot.coupled	
ES 65-32 05504	3" x 2.5"	7.5	5.5	380/660	Hm (mSS)	22	21	19	15			3,810 ₺	530 ₺	5,880 ₺		
ES 65-32 07504		10	7.5			27.5	27	25.5	22.5	15			3,810 ₺	530 ₺	6,300 ₺	
ES 65-32 11004		15	11			34	33	31	28	22.5	13			3,810 ₺	570 ₺	7,160 ₺
ES 65-32 15004		20	15			37.5	36.5	35	32.5	27.5	20			3,810 ₺	610 ₺	8,060 ₺

Flanşlar hariçtir. Takım fiyatı (Flange Set): 160 TL



## ES 65 (1500 d/d) (Yumuşak veya Mekanik Salmastralı) SALYANGOZ KAPLINLİ POMPALAR

**1500 d/d**

VOLUTE CASING LONG-COUPLED PUMPS (Soft Packing / Mechanical Seal)

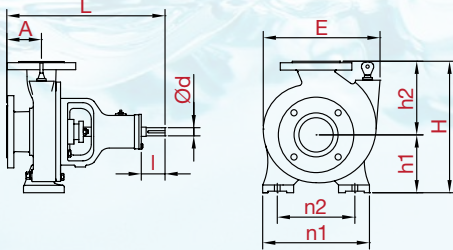
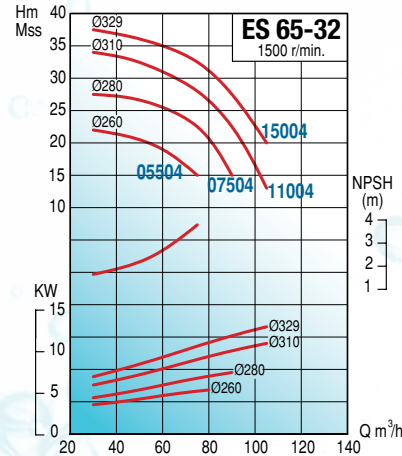
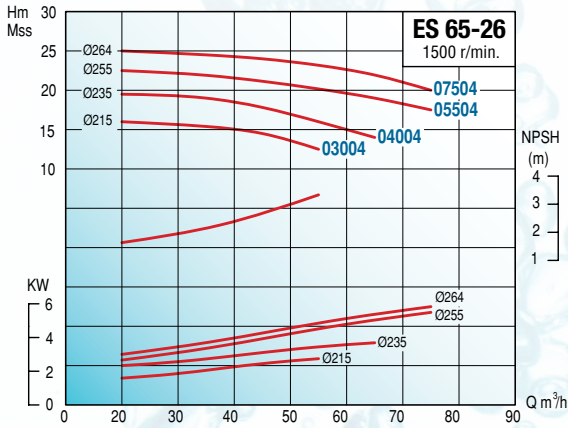
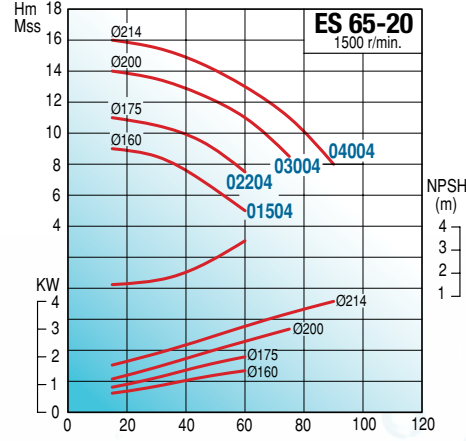
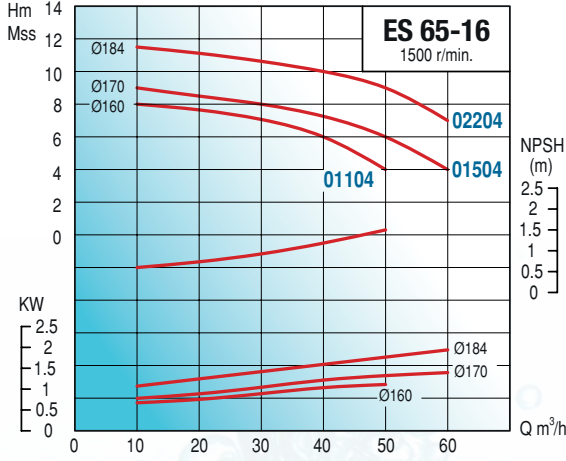

TİP TYPE	Boyutlar - Dimensions (mm)										Ağırlık - Weight
	A	L	h1	h2	H	E	n1	n2	i	d	Kg
ES 65-16	100	460	160	180	340	285	280	212	50	24	47
ES 65-20	100	460	180	225	405	335	320	250	55	24	52
ES 65-26	100	570	200	250	450	375	360	280	84	32	81
ES 65-32	125	595	225	280	505	415	400	315	84	32	106

## ES 80 (1500 d/d) (Yumuşak veya Mekanik Salmastralı) SALYANGOZ KAPLINLİ POMPALAR

**1500 d/d**

VOLUTE CASING LONG-COUPLED PUMPS (Soft Packing / Mechanical Seal)

TİP TYPE	Bağlantı Giriş x Çıkış Inlet x Outlet	MOTOR			m <sup>3</sup> /h	Debi (Q) - Capacity						Fiyat - Price (TL)			
		HP	kW	V		Hm (mSS)	30	40	50	60	70	80	Tek Pompa Bare Pump	Şasi + Kaplin	Pompa + Mot Akuple Pump&Mot.coupled
ES 80-16 01504	4" x 3"	2	1,5	380	Hm (mSS)	8,5	7,5	6,5	5,5	4		2,720 ₺	360 ₺	3,880 ₺	
ES 80-16 02204		3	2,2			10,5	10	9,5	8,5	7,5	6	2,720 ₺	360 ₺	4,020 ₺	
ES 80-16 03004		4	3			12	11,5	11	10	9	7,5	2,720 ₺	360 ₺	4,120 ₺	

Flanşlar hariçtir. Takım fiyatı (Flange Set): 160 TL

TİP TYPE	Bağlantı Giriş x Çıkış Inlet x Outlet	MOTOR			m <sup>3</sup> /h	Debi (Q) - Capacity						Fiyat - Price (TL)			
		HP	kW	V		Hm (mSS)	40	55	70	85	100	115	Tek Pompa Bare Pump	Şasi + Kaplin	Pompa + Mot Akuple Pump&Mot.coupled
ES 80-20 03004	4" x 3"	4	3	380	Hm (mSS)	11	10.5	10	9	7.5		3,050 ₺	370 ₺	4,460 ₺	
ES 80-20 04004		5.5	4	380/660		13	12.5	12	11.5	10.5		3,050 ₺	370 ₺	4,670 ₺	
ES 80-20 05504		7.5	5.5	380/660		15.5	15	14.5	14	13	12	3,080 ₺	370 ₺	5,000 ₺	

Flanşlar hariçtir. Takım fiyatı (Flange Set): 160 TL

TİP TYPE	Bağlantı Giriş x Çıkış Inlet x Outlet	MOTOR			m <sup>3</sup> /h	Debi (Q) - Capacity						Fiyat - Price (TL)			
		HP	kW	V		Hm (mSS)	40	60	80	100	115	130	Tek Pompa Bare Pump	Şasi + Kaplin	Pompa + Mot Akuple Pump&Mot.coupled
ES 80-26 04004	4" x 3"	5.5	4	380/660	Hm (mSS)	15	14.5	13.5				3,450 ₺	520 ₺	5,210 ₺	
ES 80-26 05504		7.5	5.5			17.5	17	16	15	13		3,450 ₺	520 ₺	5,510 ₺	
ES 80-26 07504		10	7.5			21.5	21	20	18.5	16.5	14	3,450 ₺	520 ₺	5,940 ₺	
ES 80-26 11004		15	11			24.5	24	23.5	22	20.5	18.5	3,450 ₺	550 ₺	6,800 ₺	

Flanşlar hariçtir. Takım fiyatı (Flange Set): 160 TL

TİP TYPE	Bağlantı Giriş x Çıkış Inlet x Outlet	MOTOR			m <sup>3</sup> /h	Debi (Q) - Capacity						Fiyat - Price (TL)			
		HP	kW	V		Hm (mSS)	40	60	80	100	115	130	Tek Pompa Bare Pump	Şasi + Kaplin	Pompa + Mot Akuple Pump&Mot.coupled
ES 80-32 07504	4" x 3"	10	7,5	380/660	Hm (mSS)	23	22	20	16			3,700 ₺	550 ₺	6,220 ₺	
ES 80-32 11004		15	11			30	29	27	25	19		3,700 ₺	550 ₺	7,040 ₺	
ES 80-32 15004		20	15			35	34	33	31	27	21	3,720 ₺	600 ₺	7,960 ₺	
ES 80-32 18504		25	18,5			37,5	37	36	35	32	26	3,720 ₺	600 ₺	8,390 ₺	

Flanşlar hariçtir. Takım fiyatı (Flange Set): 160 TL



## ES 80 (1500 d/d) (Yumuşak veya Mekanik Salmastralı) SALYANGOZ KAPLINLİ POMPALAR

**1500 d/d**

VOLUTE CASING LONG-COUPLED PUMPS (Soft Packing / Mechanical Seal)

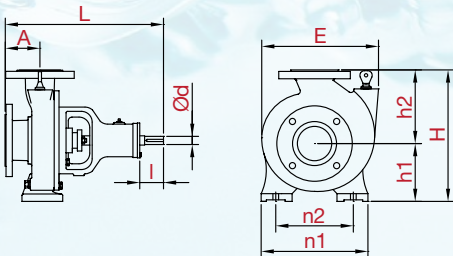
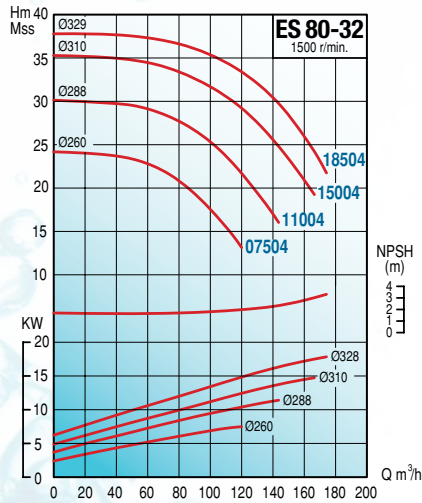
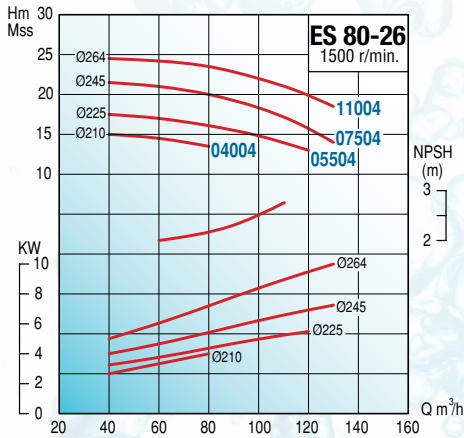
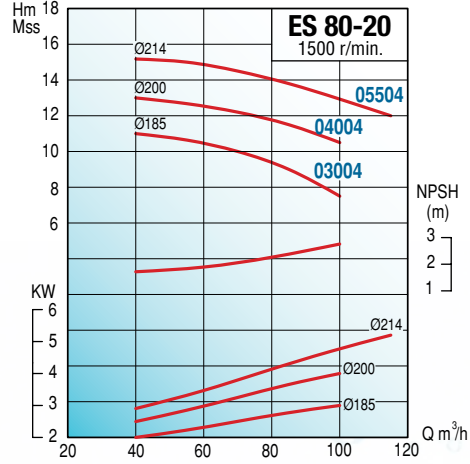
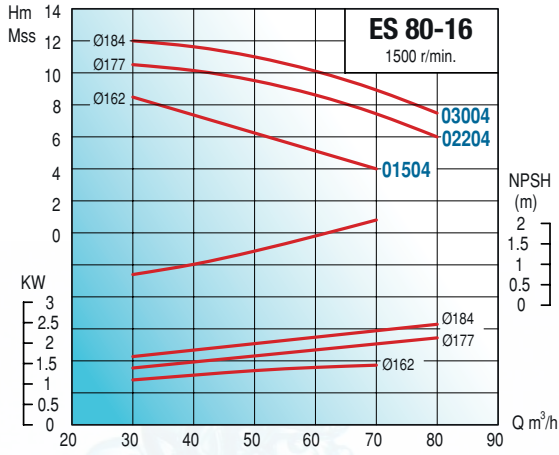

TİP TYPE	Boyutlar - Dimensions (mm)										Ağırlık - Weight
	A	L	h1	h2	H	E	n1	n2	l	d	Kg
ES 80-16	125	485	180	225	405	350	320	250	50	24	
ES 80-20	125	595	180	250	430	385	345	280	84	32	65
ES 80-26	125	595	200	280	480	420	400	315	84	32	86
ES 80-32	125	595	250	315	565	445	400	315	84	32	92

## ES 100 (1500 d/d) (Yumuşak veya Mekanik Salmastralı) SALYANGOZ KAPLINLI POMPALAR

**1500 d/d**

VOLUTE CASING LONG-COUPLED PUMPS (Soft Packing / Mechanical Seal)

TİP TYPE	Bağlantı Giriş x Çıkış Inlet x Outlet	MOTOR			m <sup>3</sup> /h	Debi (Q) - Capacity						Fiyat - Price (TL)			
		HP	kW	V		Hm (mSS)	50	80	110	140	160	180	Tek Pompa	Şasi + Kaplin	Pompa + Mot Akuple Pomp&Mot.coupled
ES 100-20 03004	5" x 4"	4.0	3	380	380 / 660	Hm (mSS)	9.5	9	8	6.5			3,250 ₺	370 ₺	4,650 ₺
ES 100-20 04004		5.5	4				12	11.5	10.5	8.5	7		3,250 ₺	370 ₺	4,860 ₺
ES 100-20 05504		7.5	5.5				14	13.5	13	11.5	10	8.5	3,250 ₺	370 ₺	5,160 ₺
ES 100-20 07504		10	7.5				16	15.5	15	13.5	12	10	3,250 ₺	370 ₺	5,590 ₺

Flaşlar hariçtir. Takım fiyatı (Flange Set): 180 TL

TİP TYPE	Bağlantı Giriş x Çıkış Inlet x Outlet	MOTOR			m <sup>3</sup> /h	Debi (Q) - Capacity						Fiyat - Price (TL)			
		HP	kW	V		Hm (mSS)	75	100	125	150	175	200	Tek Pompa	Şasi + Kaplin	Pompa + Mot Akuple Pomp&Mot.coupled
ES 100-26 05504	5" x 4"	7.5	5.5	380 / 660	Hm (mSS)	15	14	12				3,620 ₺	520 ₺	5,680 ₺	
ES 100-26 07504		10	7.5			17.5	17	16	14			3,620 ₺	520 ₺	6,110 ₺	
ES 100-26 11004		15	11			21.5	21	20.5	19.5	18			3,620 ₺	550 ₺	6,970 ₺
ES 100-26 15004		20	15			25	24.5	24	23	22	20		3,620 ₺	610 ₺	7,870 ₺

Flaşlar hariçtir. Takım fiyatı (Flange Set): 180 TL

TİP TYPE	Bağlantı Giriş x Çıkış Inlet x Outlet	MOTOR			m <sup>3</sup> /h	Debi (Q) - Capacity						Fiyat - Price (TL)				
		HP	kW	V		Hm (mSS)	100	125	150	175	200	220	Tek Pompa	Şasi + Kaplin	Pompa + Mot Akuple Pomp&Mot.coupled	
ES 100-32 11004	5"x4"	15	11	380 / 660	Hm (mSS)	23	21	18	16			3,740 ₺	550 ₺	7,080 ₺		
ES 100-32 15004		20	15			26	25	24	22	17			3,760 ₺	600 ₺	8,000 ₺	
ES 100-32 18504		25	18,5			32	29	28	26	24	23			3,760 ₺	600 ₺	8,430 ₺
ES 100-32 22004		30	22			35	33	32	30	27	26			3,760 ₺	610 ₺	9,160 ₺
ES 100-32 30004		40	30			36	35	33	32	29	27			3,790 ₺	670 ₺	10,660 ₺

Flaşlar hariçtir. Takım fiyatı (Flange Set): 180 TL





# ES 100 (1500 d/d) (Yumuşak veya Mekanik Salmastralı) **SALYANGOZ KAPLINLİ POMPALAR**

**1500 d/d**

VOLUTE CASING LONG-COUPLED PUMPS (Soft Packing / Mechanical Seal)

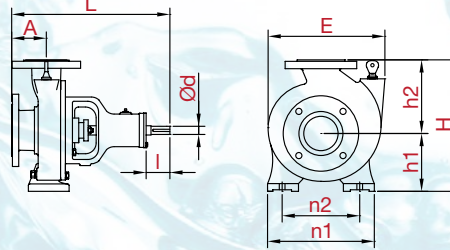
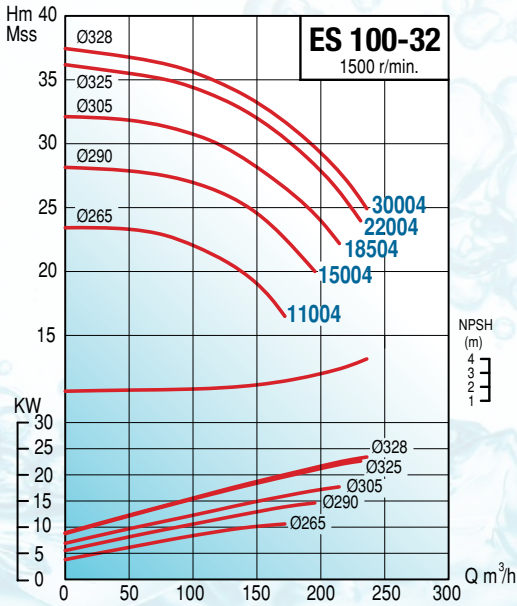
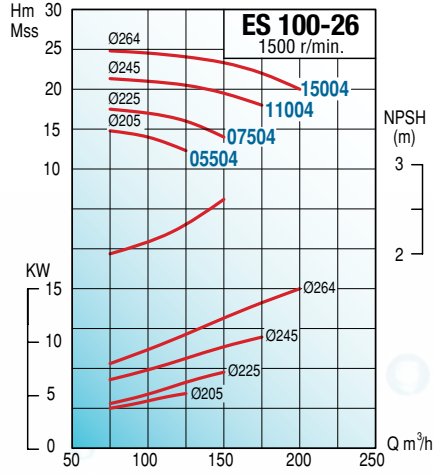
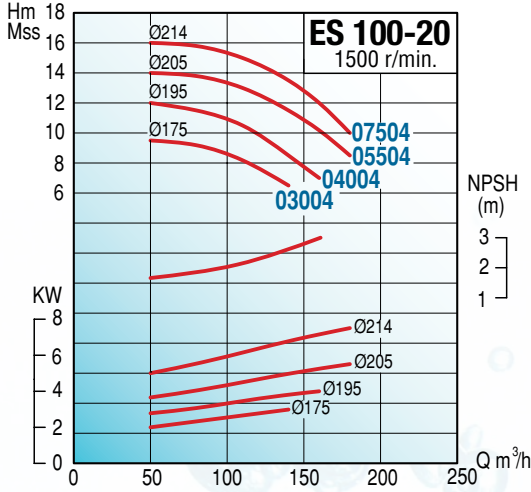

TİP TYPE	Boyutlar - Dimensions (mm)										Ağırlık - Weight
	A	L	h1	h2	H	E	n1	n2	I	d	Kg
ES 100-20	125	595	200	280	480	385	360	280	84	32	75
ES 100-26	140	610	225	280	505	420	400	315	84	32	96
ES 100-32	140	610	250	315	565	485	400	315	84	32	100